

## ENROLLMENT FORM 2011~2012

STUDENT NAME \_\_\_\_\_ AGE \_\_\_\_\_ BIRTHDATE \_\_\_\_\_  
 STUDENT NAME \_\_\_\_\_ AGE \_\_\_\_\_ BIRTHDATE \_\_\_\_\_

### CONTACT INFORMATION

NEW STUDENT  CURRENT/PAST STUDENT—RECORD RECENT INFO *CHANGES ONLY*

PARENT NAME(S) \_\_\_\_\_

EMAIL \_\_\_\_\_

HOME PHONE \_\_\_\_\_ MOBILE PHONE \_\_\_\_\_

WORK/EMERGENCY PHONE \_\_\_\_\_

ADDRESS \_\_\_\_\_ CITY \_\_\_\_\_ ZIP \_\_\_\_\_

ALLERGIES / MEDICAL CONCERNS \_\_\_\_\_

HOW DID YOU LEARN ABOUT OUR PROGRAMS? \_\_\_\_\_

### PAYMENT METHODS:

- ONE MONTHLY PAYMENT DUE WITH ENROLLMENT  
 CHECK (WRITTEN OUT TO ARTS & MUSIC CENTER)  
 CASH OR MONEY ORDER

### CLASS CHOICE

- SUMMER PIANO  
 \_\_\_\_\_ 5-LESSON PIANO SAMPLER—NEW \*BEGINNERS\*  
 \_\_\_\_\_ PAID-IN-FULL ( \$140 )  
 \_\_\_\_\_ \$28 PER LESSON  
 \_\_\_\_\_ # OF LESSONS DESIRED

DAY/TIME #1 \_\_\_\_\_  
 #2 \_\_\_\_\_

- LITTLE MOZARTS (AGES 4-6)  
 \_\_\_\_\_ ACADEMIC YEAR PAID-IN-FULL ( \$800—30-LESSON TUITION+MATERIALS )  
 \_\_\_\_\_ 10 PAYMENTS @ \$80

DAY/TIME #1 \_\_\_\_\_  
 #2 \_\_\_\_\_

- GROUP PIANO—BEGINNING (AGES 6-12)  
 PLEASE CIRCLE ALL GOOD TIMES ON BACK SIDE OF THIS PANEL

- PARTNER PIANO  
 \_\_\_\_\_ ACADEMIC YEAR PAID-IN-FULL ( \$970—34-LESSON TUITION+MATERIALS )  
 \_\_\_\_\_ 10 PAYMENTS @ \$97  
 PLEASE CIRCLE ALL GOOD TIMES ON BACK SIDE OF THIS PANEL

- PRIVATE PIANO  
 \_\_\_\_\_ ACADEMIC YEAR PAID-IN-FULL ( \$1050—34-LESSON TUITION+MATERIALS )  
 \_\_\_\_\_ 10 PAYMENTS @ \$105  
 PLEASE CIRCLE ALL GOOD TIMES ON BACK SIDE OF THIS PANEL

I AM ENROLLING MY CHILD AT ARTS & MUSIC CENTER AND UNDERSTAND THAT MY NON-REFUNDABLE PAYMENT IS DUE WITH REGISTRATION. FURTHERMORE, I RELEASE ANY AND ALL RIGHTS AND CLAIMS FOR DAMAGES AGAINST ARTS & MUSIC CENTER AND ITS STAFF IN THE UNLIKELY EVENT OF INJURY SUSTAINED BY ANY MEMBER OF MY FAMILY DURING THE COURSE OF OR AS A RESULT OF THIS MUSICAL ACTIVITY BEFORE, DURING OR AFTER LESSON TIME.

SIGNED \_\_\_\_\_

## ARTS & MUSIC CENTER

425.337.5328

Darlene Maxwell, Director info@artsandmusiccenter.com

www.artsandmusiccenter.com

Silver Lake Plaza

11419—19th Ave SE Suite C-111 Everett, WA 98208

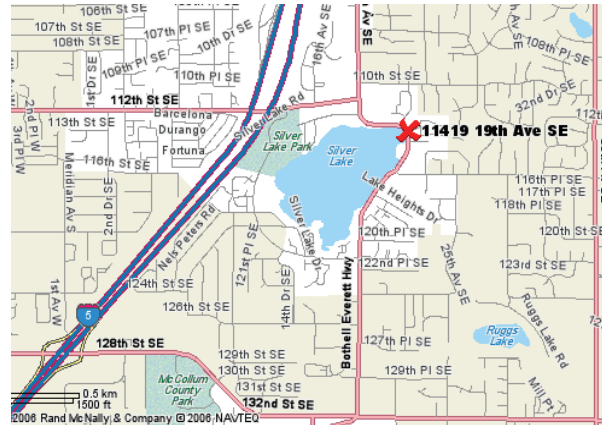

### FROM I-5:

TRAVEL EAST ON 128<sup>TH</sup> /132<sup>ND</sup> ST SE. TURN LEFT AT 19<sup>TH</sup> AVE SE (SR-527 BOTHELL-EVERETT HWY), FRED MEYER IS TO YOUR LEFT. AFTER 116<sup>TH</sup> ST AND BEFORE ROMIO'S RESTAURANT, TURN RIGHT INTO THE SILVER LAKE PLAZA (11419—19<sup>TH</sup> AVE SE), ARTS & MUSIC CENTER IS TO THE RIGHT IN BLDG C (THERE IS NO SIGN ON BLDG). STUDIO ENTRANCE IS AT END OF WETLANDS WALKWAY, JUST SOUTH OF MAMA GO ROUND AND THE L'ARTISAN FRENCH BAKERY.

### FROM NORTH MUKILTEO & NORTH EVERETT:

TRAVEL EAST ON SR-526 (BOEING HWY) AND CONTINUE SE ON SR-527 (BOTHELL-EVERETT HWY/19<sup>TH</sup> AVE), PAST COSTCO, THRU SILVER LAKE, JUST PAST ROMIO'S RESTAURANT TURN LEFT INTO THE SILVER LAKE PLAZA (11419—19<sup>TH</sup> AVE SE), ARTS & MUSIC CENTER IS TO THE RIGHT IN BLDG C (THERE IS NO SIGN ON BLDG). STUDIO ENTRANCE IS AT END OF WETLANDS WALKWAY, JUST SOUTH OF MAMA GO ROUND AND THE L'ARTISAN FRENCH BAKERY.

### FROM MILL CREEK / SNOHOMISH / SILVER FIRS AREA:

TRAVEL NORTH ON 19<sup>TH</sup> AVE SE (SR-527 BOTHELL-EVERETT HWY) PAST FRED MEYER & SILVER LAKE ELEMENTARY SCHOOL, TURN RIGHT INTO THE SILVER LAKE PLAZA (11429—19<sup>TH</sup> AVE SE), ARTS & MUSIC CENTER IS TO THE RIGHT IN BLDG C (THERE IS NO SIGN ON BLDG). STUDIO ENTRANCE IS AT END OF WETLANDS WALKWAY, JUST SOUTH OF MAMA GO ROUND AND THE L'ARTISAN FRENCH BAKERY.

NO LESSONS SCHEDULED ON THESE DATES:  
 NOV 23—27 THANKSGIVING  
 DEC 20—JAN 1 CHRISTMAS  
 SEPT 28—OCT 13 STUDIO CLOSED  
 APR 1—7 SPRING BREAK  
 JAN 12—31 STUDIO CLOSED

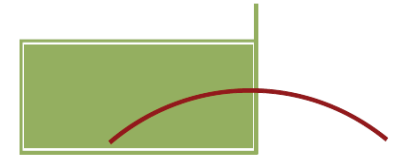

# Arts & Music Center

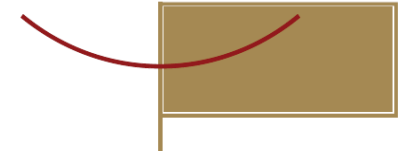

2011 ~ 2012

425.337.5328

# Summer Piano

**Ages: 5 — Teens**

FIVE: 70-min Piano Sampler—New Beginners

Two or More Lessons: 50-min Individual Private Lessons

Two or More Lessons: 60-min Partner Lessons

**SUMMER: June 28—August 11**

## To Enroll, Return This Panel

### PIANO SAMPLER—NEW \*BEGINNERS\*

This 5-lesson session is a sneak peek for Ages 6—12. Includes ensemble playing & games to develop keyboard geography and rhythmic skills.

FIVE 70-MIN LESSONS @ \$140 TUITION & MATERIALS  
SCHEDULE TBD AFTER RECEIVING YOUR INPUT BELOW:

Lesson Dates Available (circle EVERY good date)

Jun 28 29 30  
Jul 5 6 7 \* 12 13 14 \* 19 20 21 \* 26 27 28  
Aug 2 3 4 \* 9 10 11

Lesson Times Available (check EVERY good time)

Early Morn  Late Morn  Early Afternoon  Late Afternoon  Early Eve

### PIANO—PRIVATE INSTRUCTION

NOTE: ALL CURRENTLY ENROLLED PIANO STUDENTS ARE REQUIRED TO REGISTER FOR A MINIMUM OF 2 AND AS MANY AS 7 LESSONS.

CONSIDER YOUR LAST "SCHOOL YEAR" LESSON DATE AND VACATIONS. SCHEDULE TBD AFTER RECEIVING YOUR INPUT:

PRIVATE OR PARTNER AGES 5—TEEN

SIGN ME UP FOR \_\_\_\_\_ (#) OF SUMMER LESSONS @ \$28 EA LESSON

Tues-Wed-Thurs Lesson Dates Available (circle EVERY good date)

Jun 28 29 30  
Jul 5 6 7 \* 12 13 14 \* 19 20 21 \* 26 27 28  
Aug 2 3 4 \* 9 10 11

Lesson Times Available (check EVERY good time):

Early Morn  Late Morn  Early Afternoon  Late Afternoon  Early Eve  
 Please keep my current lesson daytime (Tues-Wed-Thurs only)

STUDENT NAME \_\_\_\_\_ AGE \_\_\_\_\_ BIRTHDATE \_\_\_\_\_

PARENT NAME(S) \_\_\_\_\_ EMAIL \_\_\_\_\_

TELEPHONE \_\_\_\_\_ MOBILE PHONE \_\_\_\_\_ WORK \_\_\_\_\_

ADDRESS \_\_\_\_\_ CITY \_\_\_\_\_ ZIP \_\_\_\_\_

#### PAYMENT IN FULL

CHECK (PAY TO THE ORDER OF ARTS & MUSIC CENTER)  
 CASH OR MONEY ORDER

#### REMEMBER TO MARK YOUR CLASS CHOICE(S) ABOVE

I AM ENROLLING MY CHILD FOR THE ARTS & MUSIC CENTER SUMMER MUSIC & UNDERSTAND THAT MY NON-REFUNDABLE PAYMENT IS DUE WITH REGISTRATION. FURTHERMORE, I RELEASE ANY AND ALL RIGHTS AND CLAIMS FOR DAMAGES AGAINST ARTS & MUSIC CENTER AND ITS STAFF IN THE UNLIKELY EVENT OF INJURY SUSTAINED BY ANY MEMBER OF MY FAMILY DURING THE COURSE OF OR AS A RESULT OF THIS MUSICAL ACTIVITY BEFORE, DURING OR AFTER LESSON TIME. ARTS & MUSIC CENTER RESERVES THE RIGHT TO CANCEL OR REVISE CLASSES DUE TO ENROLLMENT NEEDS.

SIGNED \_\_\_\_\_

# Little Mozarts

**Ages: 4 — 6 yrs**

Innovative Piano Instruction for Young Children

55-min Class w/Caregiver—Academic School Year

**October 19 – June 20 (30 lessons)**

Music, PIANO and Movement

- ♫ CREATIVE FUN
- ♫ MAKE MUSIC
- ♫ SING
- ♫ PLAY PIANO
- ♫ PLAY MISC PERCUSSION INSTRUMENTS
- ♫ READ MUSIC NOTES AND RHYTHMS
- ♫ DEVELOPMENTALLY APPROPRIATE
- ♫ NO-PRESSURE PACE

#### AT-HOME EQUIPMENT REQUIRED:

Portable CD Player

Keyboard—Acoustic or

Digital—61+ full-size key, touch-sensitive or weighted action

#### TUITION

ACADEMIC YEAR PAID-IN-FULL ( \$800—30-LESSON TUITION+MATERIALS )

10 PAYMENTS @ \$80

#### SCHEDULE

WEDNESDAY: 12:30— 1:25

1:30— 2:25

THURSDAY: 10:30—11:25

1:30— 2:25



# Private & Group Piano

**Ages: 6 — Teens**

50-min Individual Private Lessons—Academic School Year

60-min Partner Lessons—Academic School Year

**September 7 – June 30 (34 lessons)**

Learn to Play PIANO

- ♫ MUSIC MAKING FUN
- ♫ STRONG RHYTHM EMPHASIS
- ♫ DEVELOP MUSICIANSHIP
- ♫ WIDE RANGE OF MUSIC STYLES
- ♫ MULTI-HAND POSITION APPROACH
- ♫ EAR TRAINING & SIGHT READING
- ♫ NO-PRESSURE PACE



#### AT-HOME EQUIPMENT REQUIRED:

Portable CD Player

Keyboard—Acoustic or Digital (61+ full-size key, touch-sensitive or weighted action)

#### TUITION

GROUP (AGES 6-12)

ACADEMIC YEAR PAID-IN-FULL ( \$970—34-LESSON TUITION+MATERIALS )

10 PAYMENTS @ \$97

PARTNER PIANO

ACADEMIC YEAR PAI-IN-FULL ( \$970—34-LESSON TUITION+MATERIALS )

10 PAYMENTS @ \$97

PRIVATE PIANO

ACADEMIC YEAR PAID-IN-FULL ( \$1050—34-LESSON TUITION+MATERIALS )

10 PAYMENTS @ \$105

#### SCHEDULE

ALL TIMES LISTED ARE APPROX UNTIL IT'S KNOWN WHO NEEDS GROUP, PARTNER OR PRIVATE LESSONS

MON	TUES	WED	THURS	FRI	SAT
			7:50/8:00am		8:30am
			8:50am		9:30
			10:30am		10:05
3:05pm	2:20pm	3:05pm	2:20pm	1:20pm	10:40
4:05	3:10	3:40	3:10	1:50	11:15
5:05	4:20	4:15	3:45	2:25	11:50pm
6:15	5:10	5:05	4:35	3:15	12:25
7:15	6:10	6:05	5:35	4:15	1:00
7:50	7:10	7:05	6:35	4:50	1:35
	8:10	8:15	7:15	5:25	2:10
			8:10	6:15	2:45
				7:15	3:20